

Installationsanvisning

RONDO 70x90x205cm



Vigtig information, før du starter.

1) Generel information.









Sørg for at kontrollere produktet grundigt ved modtagelsen. Skulle der forekomme mangler eller skader skal disse meldes til forhandler/producent. Vær forsigtig ved håndtering af glassdelene, og undgå at sætte glasset direkte på hårde overflader.

Eventuelle skaver på glasset efter produktet er pakket ud, vil ikke blive betragtet som et gyldigt grundlag for reklamation.

Vær opmærksom på aluminiumsprofilerne godt kan have mærker fra produktion, da materialet er blødt under fremstillingen er blevet poleret, ekstruderet eller anodiseret. Profilerne i kvalitetskontrollen er blevet testet og godkendt i anvendelse af kabinen.

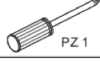
2) Ekstra information.

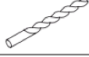
Sørg for at gennemgå manualerne grundigt før samlingen påbegyndes. Vær opmærksom på den ønskede placering af kabinen giver mulighed for vandtilførsel samt gulvafløb. Da flere af delene kan være tunge, og/eller svære af håndtere anbefales det man er to til at foretage samlingen af kabinen.

Nødvendigt værktøj			
Målebånd		Boremaskine	
Vaterpas		Skruetrækker	
Blyant		Stjerneskruetrækker	
Ø6 mm bor		Hammer	
Ø3 mm bor		Silikonefugemasse	

OBS, det er et tungt produkt og kan være svært at håndtere, så det anbefales at man er to til at samle kabinen.

INDHOLD

DEL 1/4

- ① 1 x komplet bundkar med afløb

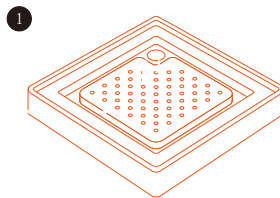

DEL 2/4

- ① 2x Sideglas med monterede aluminiumsprofiler
- ② 2x Glasdøre
- ③ 4x horisontale aluminiumsprofiler
- ④ Gummiliste sæt:
A 4x korte gummilister til sideglas
B 4x lange gummilister til montering på sideglas og dør
(2stk er for monteret)
C 2x magnetlister til dørene

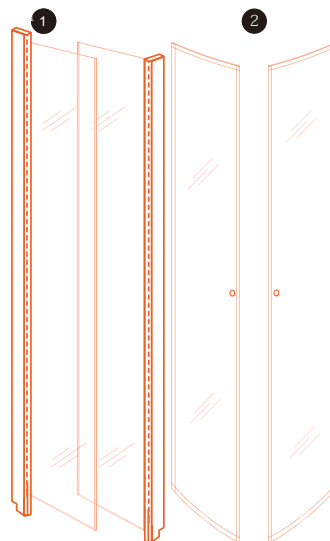
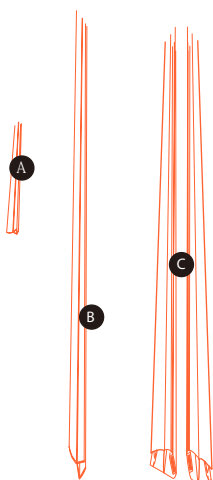
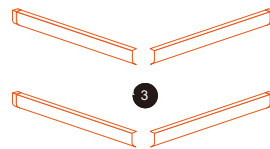

INDHOLD

DEL 3/4

- ① 2x Glas bagvægge

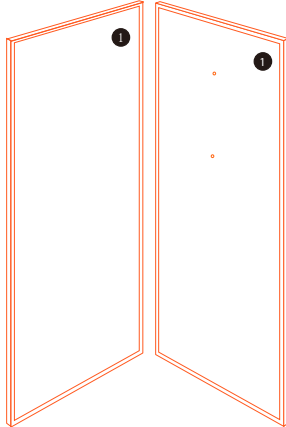

OBS ! OBS ! OBS !



Glas:
I det omfang det er muligt, bør man altid være 2 personer, til at løfte og håndtere glasset.



Er man alene, bør man altid løfte på tværs af glaspladerne, og ikke lige over midten.



Glasset er tungt, og har tyngde i begge ender, og kan derfor gå i stykker, hvis man behandler det forkert.

DEL 4/4

- ① 1x Bagpanel
② 1x Spejl
③ 1x Komplet brusestangssæt
④ 1x Pose med løsdele
A 2x Dørhåndtag
B 4x Tophjul
C 4x Bundhjul
D 8x Skruer M4x25
E 20x Skruer M4x12
F 4x Skruer M4x20
G HJØRNE

④

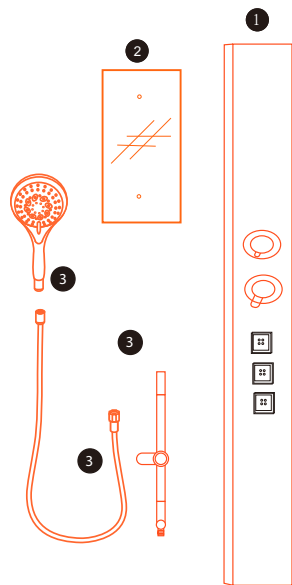

SAMLEVEJLEDNING

- 1 Fronten på bundkarret er for monteret

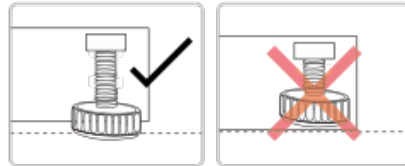
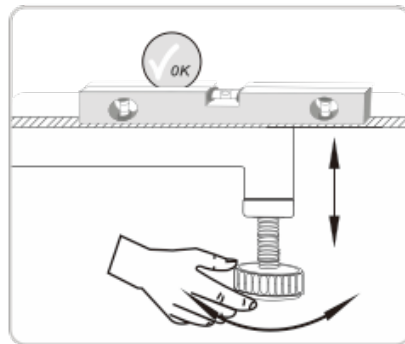
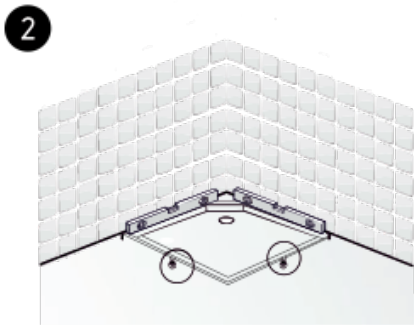
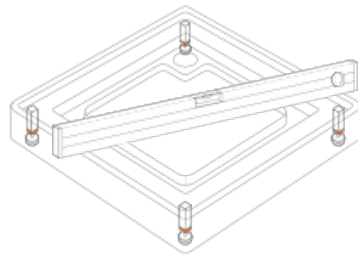
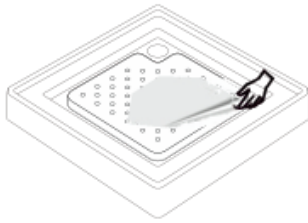

SAMLEVEJLEDNING

3

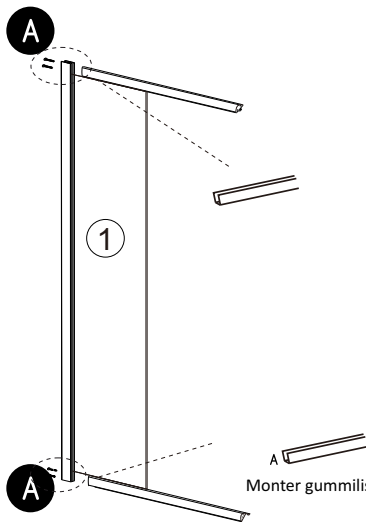
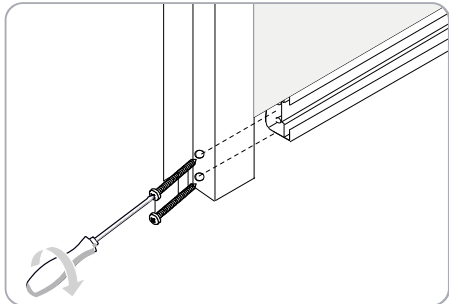
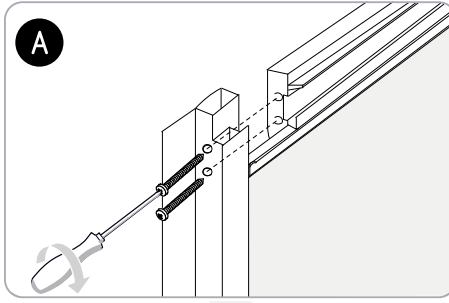
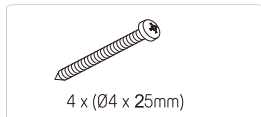
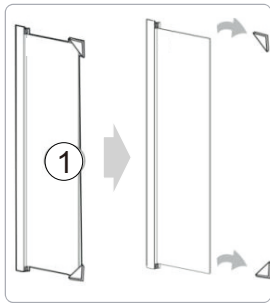

Monter gummiliste på sideglasset før det monteres i profilerne.

SAMLEVEJLEDNING

4

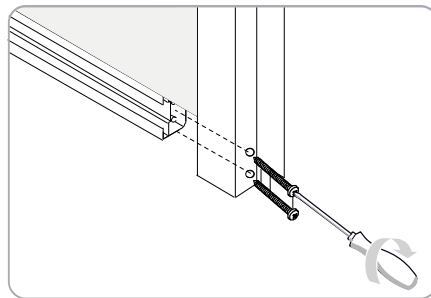
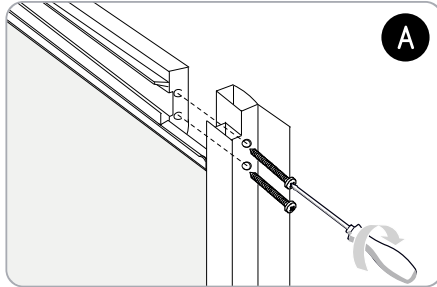
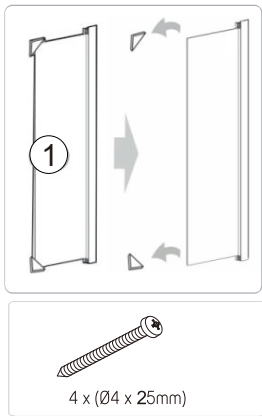

5

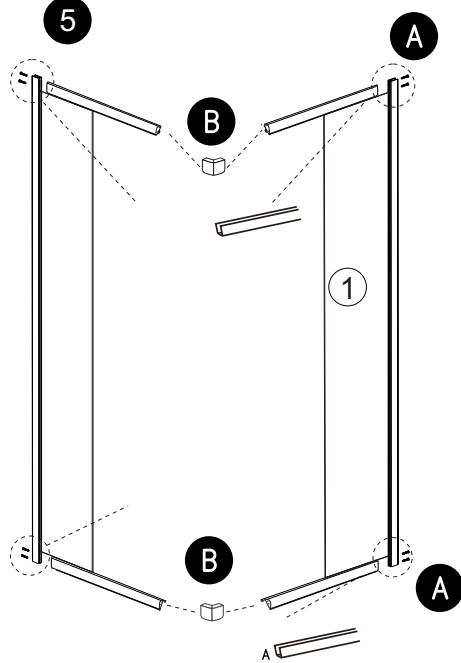

B

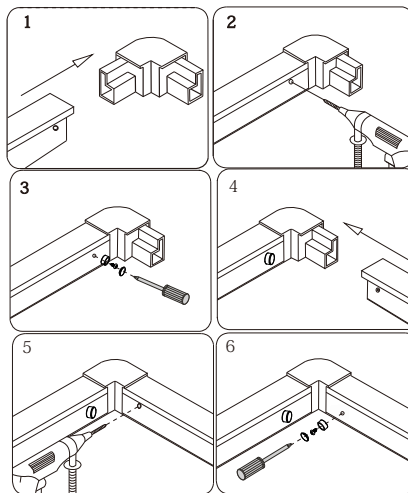

Monter gummiliste på sideglasset før det monteres i profilerne.

6

SAMLEVEJLEDNING

6

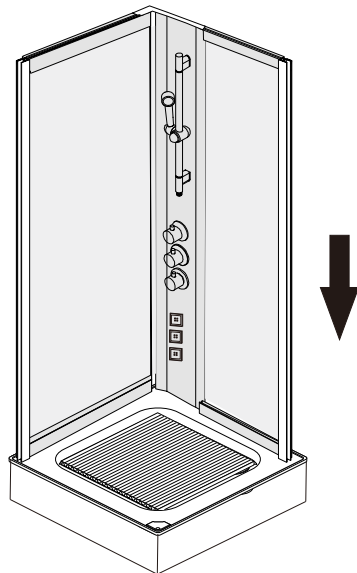
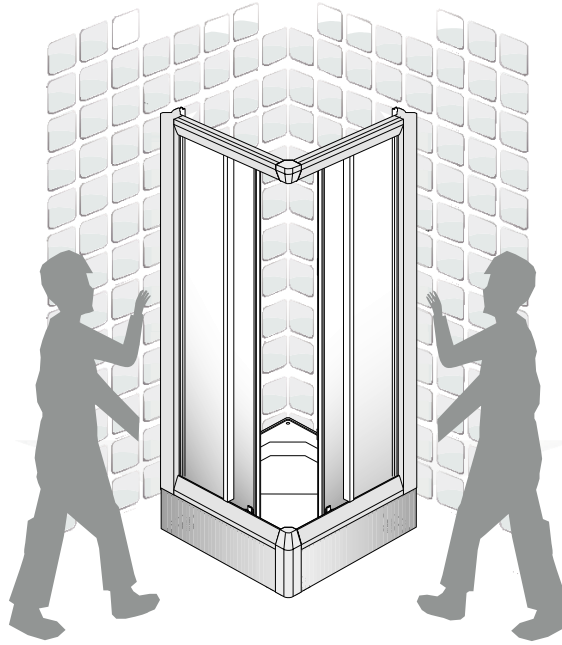

SAMLEVEJLEDNING

7

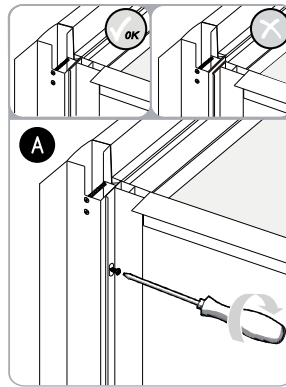
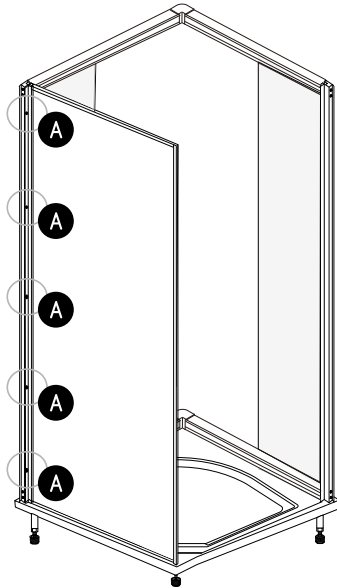

8

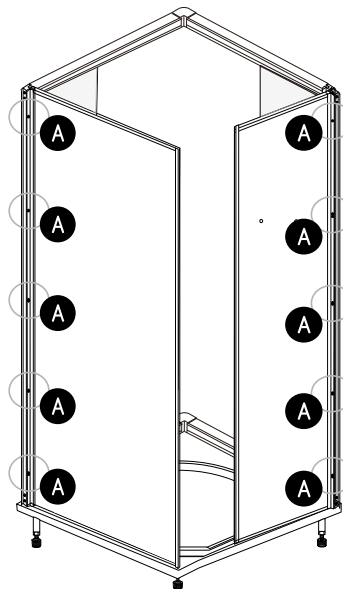
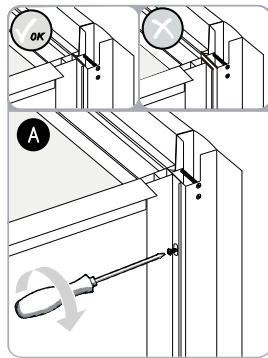

SAMLEVEJLEDNING

9

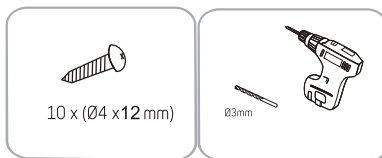
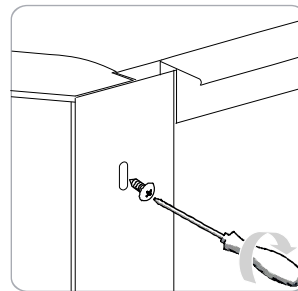
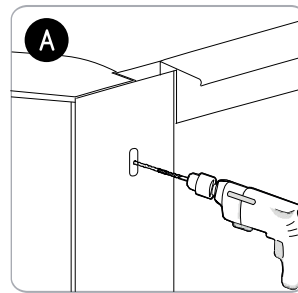
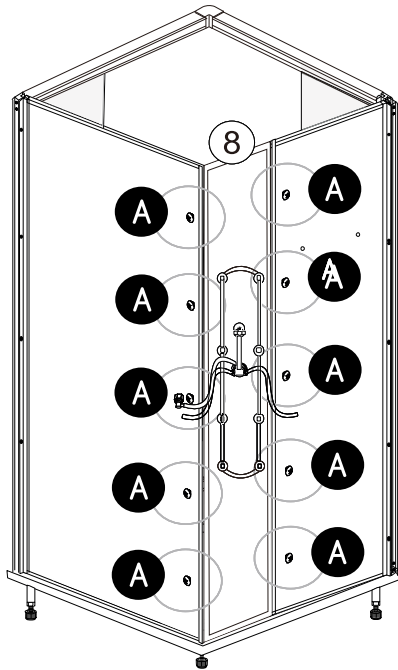
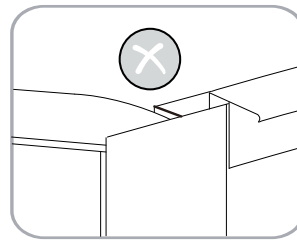
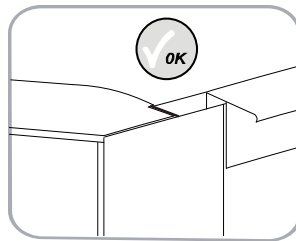

SAMLEVEJLEDNING

10

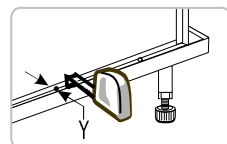
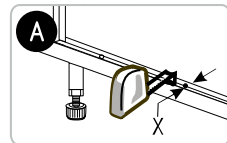
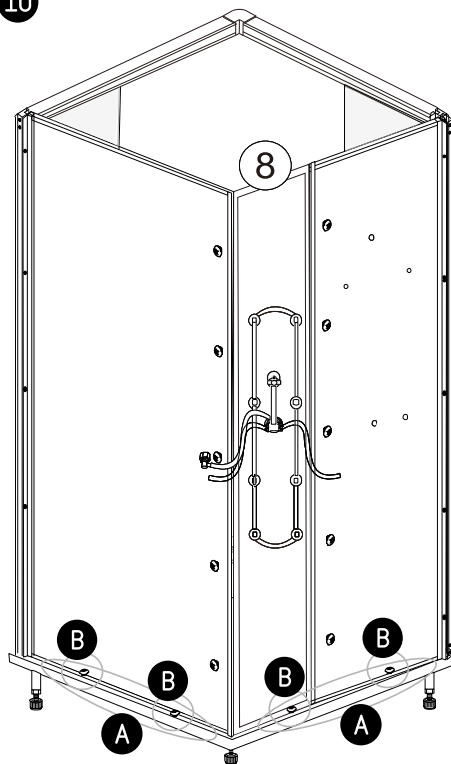

⚠ X = Y ⚠

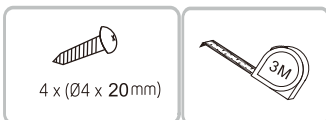
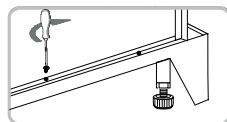
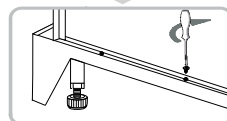
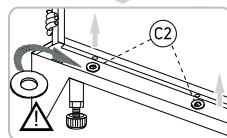
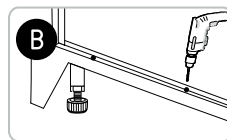

Fastgør kabinen på bundkaret. Placer en kant af vådrumssilikone inden kabinen løftes på.

SAMLEVEJLEDNING

11

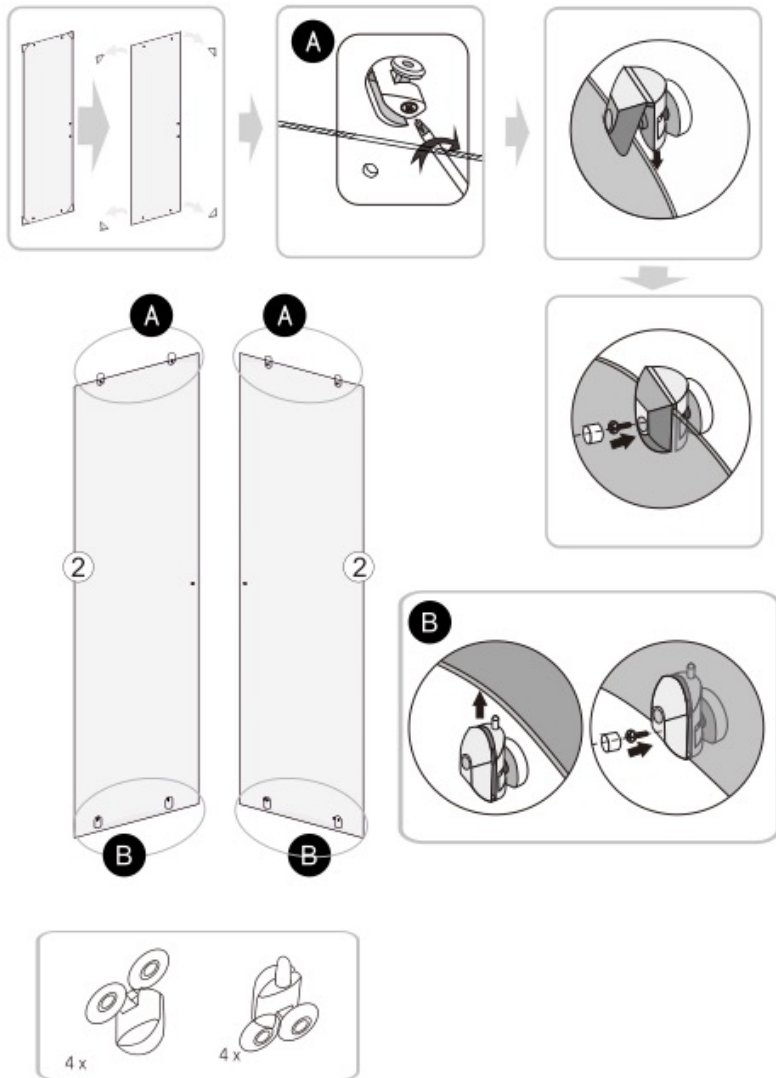

SAMLEVEJLEDNING

12

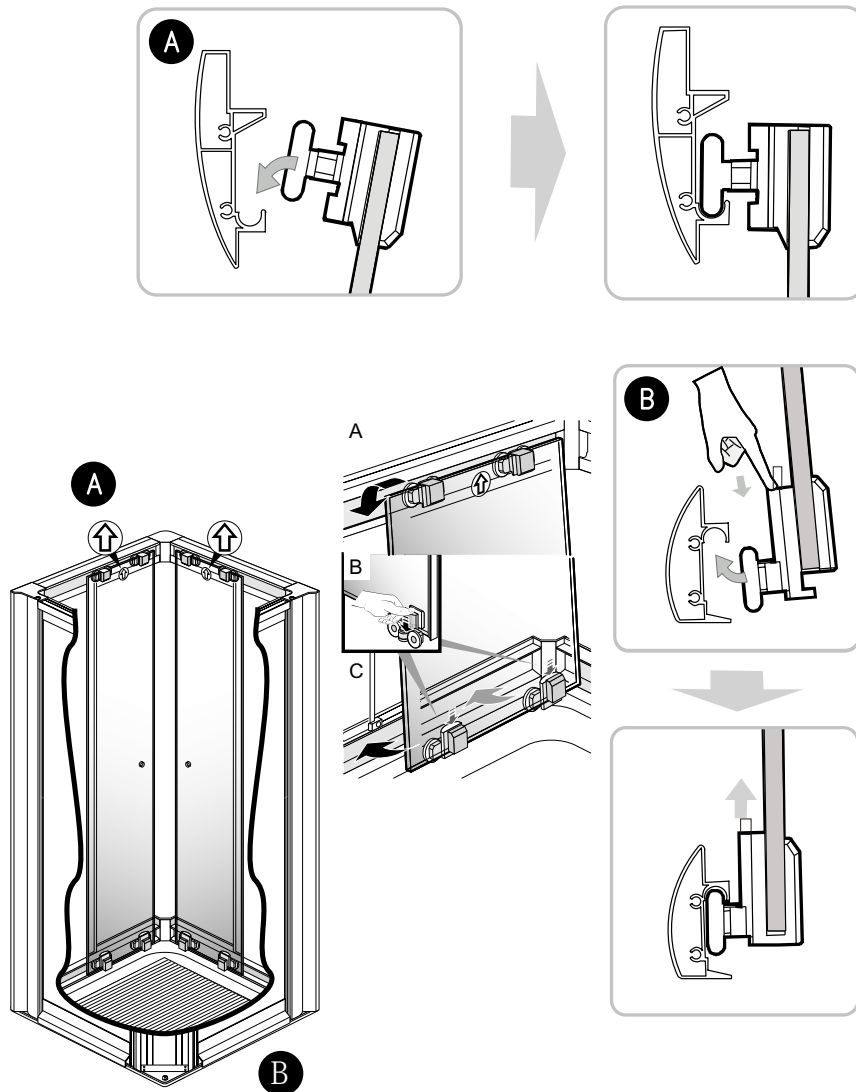

SAMLEVEJLEDNING

13

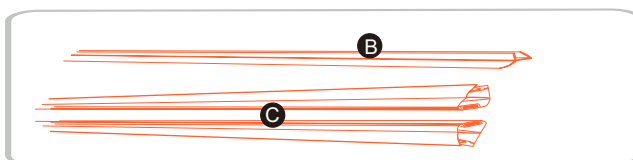
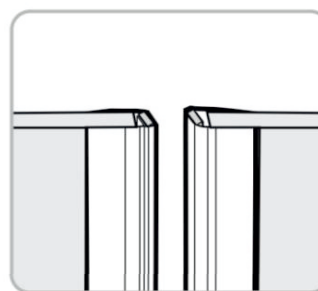
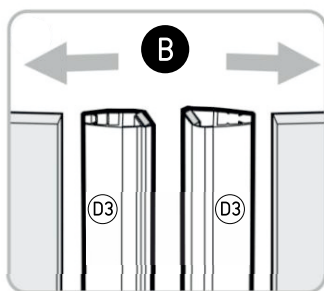
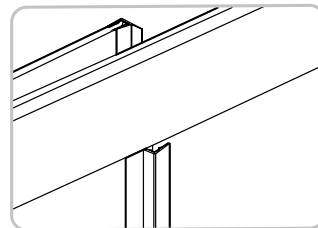
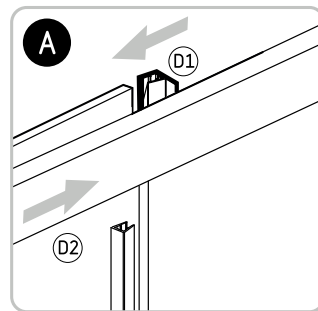
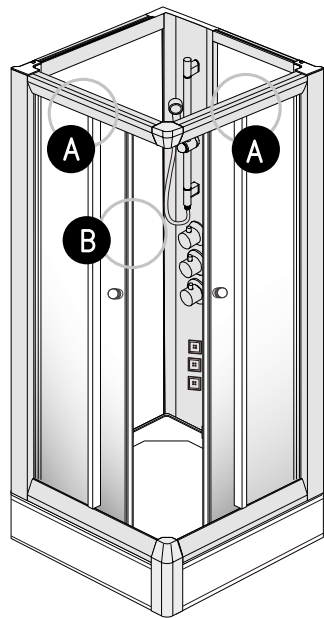

SAMLEVEJLEDNING

14

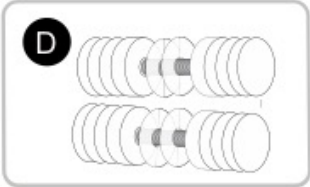
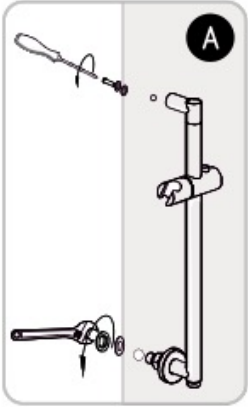
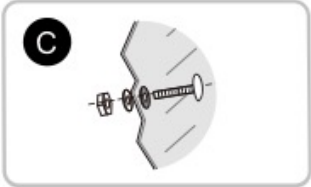

SAMLEVEJLEDNING

16

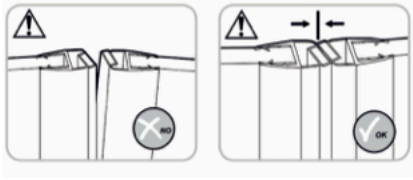
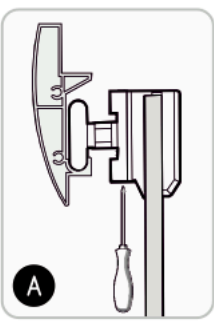
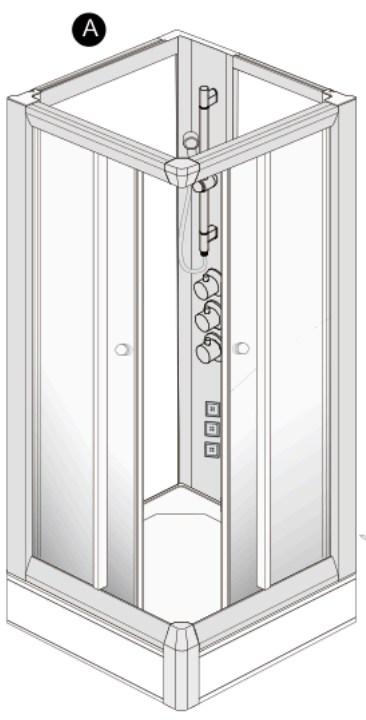

Brug silikone mellem bundprofil og bundkar.